



# Rain Water Piping System



## PIPES

MODEL	NOM. SIZE (mm)	SPECIFICATION
Light Duty	82, 110	BS 4576:PT.1:1989
Medium Duty	110, 160, 200, 250 & 315	BSEN 1329-1:2000(BD)/MS 1063:2002(BD)
Heavy Duty	110, 160 & 200	DIN 8061

## FITTINGS

MODEL	NOM. SIZE (mm)	SPECIFICATION
Swept Bend	110, 160, 200, 250 & 315	BSEN 1329-1:2000(BD)/MS 1063:2002(BD)/BSEN 1401-1
Swept Bend	82	BS 4514:2001(BD)/MS 1063:2002(BD)
Boss Connector with Bracket	110x82 & 160x82	BS 4514:2001(BD)/MS 1063:2002(BD)
Bush Socket Reducer	160x110	BSEN 1329-1:2000(BD)/MS 1063:2002(BD)
Bush Socket Reducer	110x82	BS 4514:2001(BD)/MS 1063:2002(BD)
Concentric Reducer	160x110	BSEN 1329-1:2000(BD)/MS 1063:2002(BD)
Unswep Bend	110, 160, 200, 250 & 315	BSEN 1329-1:2000(BD)/MS 1063:2002(BD)/BSEN 1401-1
Unswep Bend	82	BS 4514:2001(BD)/MS 1063:2002(BD)
Unswep Equal Single Branch	110, 160, 200, 250, 315	BSEN 1329-1:2000(BD)/MS 1063:2002(BD)/BSEN 1401-1
Unswep Equal Single Branch	82	BS 4514:2001(BD)/MS 1063:2002(BD)
Unswep Unequal Double Branch	160x110	BSEN 1329-1:2000(BD)/MS 1063:2002(BD)
Swept Equal Single Branch	110, 160, 200, 250 & 315	BSEN 1329-1:2000(BD)/MS 1063:2002(BD)/BSEN 1401-1
Swept Equal Single Branch	82	BS 4514:2001(BD)/MS 1063:2002(BD)
Swept Equal Double Branch	110	BSEN 1329-1:2000(BD)/MS 1063:2002(BD)
Inspection Opening & Frame	110x82, 160x82	BS 4514:2001(BD)/MS 1063:2002(BD)
Level Invert Reducer	110x82	BS 4514:2001(BD)/MS 1063:2002(BD)
Level Invert Reducer	160x200, 160x250, 160x315, 200x250, 200x315 & 250x315	BSEN 1401-1
Straight Coupler	110, 160, 200, 250 & 315	BSEN 1329-1:2000(BD)/MS 1063:2002(BD)
Straight Coupler	82	BS 4514:2001(BD)/MS 1063:2002(BD)
Unswep Unequal Single Branch	160x110, 200x160, 250x160, 250x200	BSEN 1329-1:2000(BD)/MS 1063:2002(BD)/BSEN 1401-1
Unswep Unequal Single Branch	110x82	BS 4514:2001(BD)/MS 1063:2002(BD)
Swept Unequal Double Branch	160x110	BSEN 1329-1:2000(BD)/MS 1063:2002(BD)



CERTIFIED TO ISO 9001:2015  
CERT. NO. 1443612

## Rainwater Pipes

Rainwater Piping System has been developed to meet the need of construction industry for a reliable piping system for channeling rainwater from the roof to the drains. The system is suitable for all applications and types of building, including domestic, commercial and industrial.

As the scope of BS 4576: Part 1: 1989 for Rainwater Goods & Accessories covers rainwater pipes in nominal sizes from 63mm to 110mm only, additional sizes and classes of rainwater pipes have been incorporated in the Rainwater Piping System to meet different requirements of BSEN1329-1, BS 4576/1, MS1063 and DIN 8061.

The Light-Duty pipe is intended for exposed installation on the buildings that do not exceed two storeys in height, such as terrace houses or low-rise shop-houses. The Medium-Duty is intended for exposed installation on building exceeding two storeys while the Heavy-Duty is designed with higher ring stiffness for use in pipework to be encased in reinforced concrete (RC) columns.

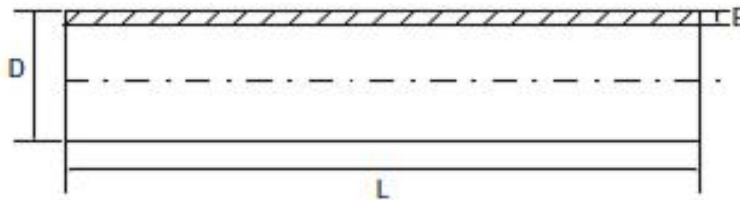

### PIPE DIMENSIONS

CODE NO.	CLASS	NOM. SIZE (mm)	SPECIFICATION	PIPE END	OUTSIDE DIAMETER D (mm)	WALL THICKNESS E (mm)	TYPICAL PIPE STIFFNESS (MPa)	LENGTH L (meter)
5100 082 40	Light Duty	82	BS 4576/1	PE	82.4 - 82.8	1.8 - 2.3	0.003	4
5100 110 40	Light Duty	110	BS 4576/1	PE	110.0 - 110.4	2.2 - 2.7	0.002	4
5100 110 60	Light Duty	110	BS 4576/1	PE	110.0 - 110.4	2.2 - 2.7	0.002	6
1200 110 40	Medium Duty	110	BSEN1329-1/MS1063	PE	110.0 - 110.3	3.2 - 3.8	0.006	4
1200 110 60	Medium Duty	110	BSEN1329-1/MS1063	PE	110.0 - 110.3	3.2 - 3.8	0.006	6
5102 110 60 HD	Heavy Duty	110	DIN 8061	SS	110.0 - 110.3	6.0 - 6.8	0.043	6
5100 160 60 MD	Medium Duty	160	BSEN1329-1/MS1063	PE	160.0 - 160.4	4.3 - 4.6	0.004	6
5102 160 60 HD	Heavy Duty	160	DIN 8061	SS	160.0 - 160.4	8.7 - 9.7	0.043	6
5102 200 60 MD	Medium Duty	200	BSEN1329-1/MS1063	SS	200.0 - 200.5	4.9 - 5.6	0.004	6
5102 200 60 HD	Heavy Duty	200	DIN 8061	SS	200.0 - 200.4	10.8 - 12.0	0.042	6
5102 250 60 MD	Medium Duty	250	BSEN1329-1/MS1063	SS	250.0 - 250.5	6.2 - 7.1	0.004	6
5102 315 60 MD	Medium Duty	315	BSEN1329-1/MS1063	SS	315.0 - 315.6	7.7 - 8.7	0.004	6

PE: Plain End

SS: Solvent Socket

Light & Medium Duty: White

Heavy Duty: Greyish White

**Swept Bend**

CODE NO.	NOM. SIZE (mm)	ANGLE °	L	DIMENSIONS (mm)		
				A	B	D
2201 082	82	87½°	43	80	76	82
2201 110	110	87½°	51	75	71	110
2201 160	160	87½°	76	129	129	160
* 2201 200	200	89°	94/100	120	116	200

Available on Inspection Opening  
 D: Nominal Dimension  
 \* Available in MF & FF

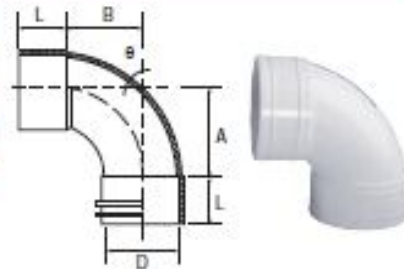

**87°30' Bend All Socket**

CODE NO.	NOM. SIZE (mm)	ANGLE °	L	DIMENSIONS (mm)		
				A	B	D
02420	200	87½°	85	124	124	200
02425	250	87½°	101	154	154	250
02430	315	87½°	116.5	192	192	315

Imported fittings  
 D: Nominal Dimensions

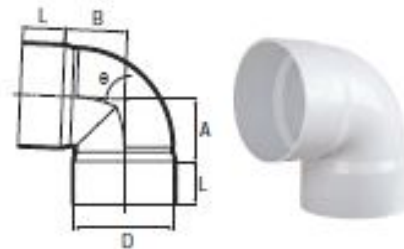

**Unswept Bend**

CODE NO.	NOM. SIZE (mm)	ANGLE °	L	DIMENSIONS (mm)		
				A	B	D
• 2210 082	82	45°	43	15	15	82
• 2210 110	110	45°	50	20	20	110
• 2210 160	160	45°	76	30	30	160
* 2205 110	110	68°	52	60	53	110
* 2210 110 139	110	41°	50	15	25	110
* 2205 160	160	68°	80	75	72	160
* 2205 200	200	68°	100	97	96	200

Available in Rubber Ring Joint  
 D: Nominal Dimensions  
 • Available on Inspection Opening  
 • Available in MF  
 \* Available in FF  
 • Available in MF & FF

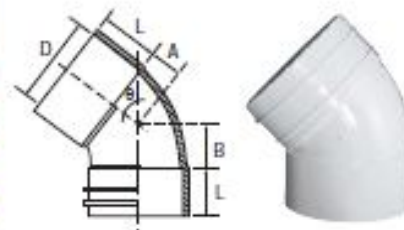

**45° Bend All Socket**

CODE NO.	NOM. SIZE (mm)	ANGLE °	L	DIMENSIONS (mm)		
				A	B	D
02320	200	45°	85	65	65	200
02325	250	45°	101	79	79	250
02330	315	45°	116.5	100	100	316

Imported fittings  
 D: Nominal Dimensions

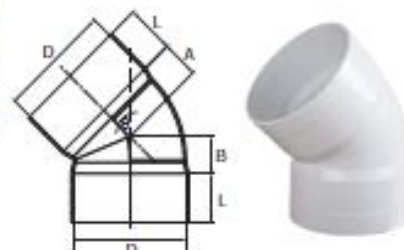

**Swept Branch**

CODE NO.	NOM. SIZE (mm)	ANGLE		DIMENSIONS (mm)						
		φ	L	A	B	C	E	D	D1	
2211 082	82	87½°	45.0	76	206	-	43	82	82	
2211 110	110	87½°	50.0	75	250	-	56	110	110	
2211 160	160	87½°	77.0	155	360	83	56	160	160	
+ 2211 160 110	160x110	87½°	160.3	125	372	-	56	160	110	

Available on Inspection Opening  
 + Reducing Branch  
 D & D1: Nominal Dimensions



**87°30' Branch (One Spigot End)**

CODE NO.	NOM. SIZE (mm)	ANGLE		DIMENSIONS (mm)						
		φ	L	L1	A	B	M	D	D1	
03520	200	87½°	86	74	206	361	200	200	200	
03420	200x160	87½°	86	86	206	411	200	200	160	
03425	250	87½°	103	103	255	510	250	250	250	
03430	315	87½°	116.5	116.5	301.5	616	315	315	315	

Imported fittings  
 D & D1: Nominal Dimensions

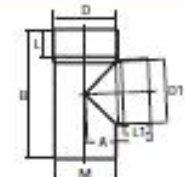

**45° Branch (One Spigot End)**

CODE NO.	NOM. SIZE (mm)	ANGLE		DIMENSIONS (mm)						
		φ	L	L1	B	B1	M	D	D1	
03016	160	45°	72	72	400	279	160	160	160	
03120	200x160	45°	86	74	430	304	200	200	160	
03020	200	45°	86	86	483	338	200	200	200	
03140	250x160	45°	103	74	485	336	250	250	160	
03141	250x200	45°	103	86	539	370	250	250	200	
03025	250	45°	103	103	609	418	250	250	250	
03030	315	45°	116.5	116.5	725.5	508.5	315	315	315	

Imported fittings  
 D & D1: Nominal Dimensions

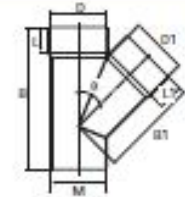

**Unswapt Branch**

CODE NO.	NOM. SIZE (mm)	ANGLE		DIMENSIONS (mm)						
		φ	L	L1	B	C	E	D	D1	
2213 082	82	45°	44	44	105	-	43	82	82	
2213 110	110	45°	51	51	155	83	56	110	110	
2213 110 082	110x82	45°	50	50	155	83	56	110	82	
2213 160 110	160x110	45°	76	50	148	83	56	160	110	

Available on Inspection Opening  
 Available in Rubber Ring Joint  
 D & D1: Nominal Dimensions

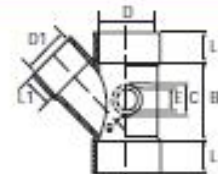

## 45° Reducing Double Branch

CODE NO.	NOM. SIZE (mm)	ANGLE °	DIMENSIONS (mm)							
			L	L1	B	C	E	D	D1	
2218 160 110	160x110	45°	76.2	52.8	315	83	56	160	110	

Available on Inspection Opening  
Available in Rubber Ring Joint  
D & D1: Nominal Dimensions

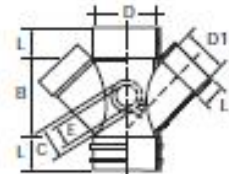

## 87.30° Equal Double Branch

CODE NO.	NOM. SIZE (mm)	ANGLE °	DIMENSIONS (mm)				
			L	C	E	D	D1
2216 110	110	87½°	50.5	83	56	110	110

Available on Inspection Opening  
D & D1: Nominal Dimensions

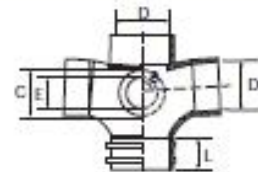

## Straight Coupler

CODE NO.	NOM. SIZE (mm)	DIMENSIONS (mm)			
		L	A	B	D
2225 082	82	42	3	96	82
2225 110	110	51	3.2	112	110
2225 160	160	77	4.3	161	160
* 2225 200	200	108	7.8	294	200
* 2225 250	250	112	110	334	250
* 2225 315	315	128	90	346	315

Available in Rubber Ring Joint \* Fabrication Item  
D: Nominal Dimensions

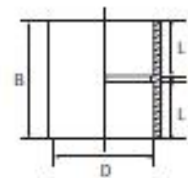

## Concentric Reducer

CODE NO.	NOM. SIZE (mm)	DIMENSIONS (mm)				
		L	L1	L2	D	D1
2239 160 110	160x110	146	75	47	160	110

D & D1: Nominal Dimensions

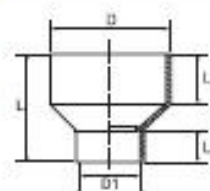

**Level Invert Reducer**

CODE NO.	NOM. SIZE (mm)	DIMENSIONS (mm)				
		L	L1	A	D	D1
2239 110 082	110x82	43	50	35	110	82

D & D1: Nominal Dimensions

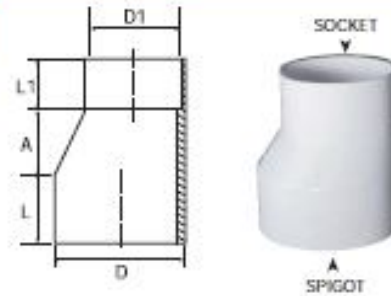

**Level Invert Reducer**

CODE NO.	NOM. SIZE (mm)	DIMENSIONS (mm)				
		L	L1	A	D	D1
05140	200X160	100	74	39	200	160
05146	250X160	125	73	61.5	250	160
05125	250X200	134	86	46	250	200
05133	315X200	145	86	87	315	200
05130	315X250	144	103	61	315	250

Imported fittings

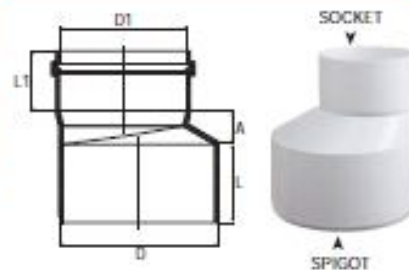

**Level Invert Reducer**

CODE NO.	NOM. SIZE (mm)	DIMENSIONS (mm)				
		L	L1	A	D	D1
05348	315X160	93	74	19	315	160

Imported fittings

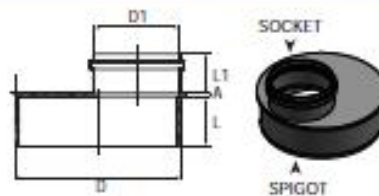

**Bush/Socket Reducer**

CODE NO.	NOM. SIZE (mm)	DIMENSIONS (mm)				
		L	L1	D	D1	
2236 110 82	110x82	50	37	110	82	
2236 160 110	160x110	71	48.5	160	110	

D & D1: Nominal Dimensions

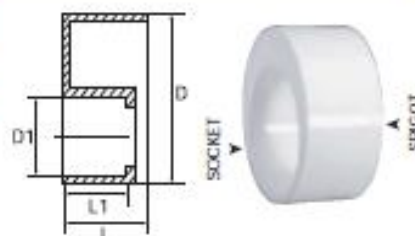

## Boss Connector with Bracket

CODE NO.	NOM. SIZE (mm)	DIMENSIONS (mm)		
		Dr	D	A
2243 110 082	110x82	110	82	45.0
2243 160 082	160x82	160	82	45.0

Dr- Nominal diameter pipe  
D - Diameter of inlet pipe  
A - Socket depth

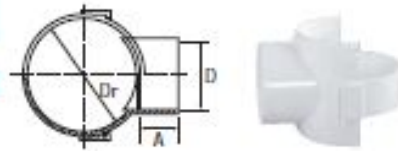

## Inspection Opening &amp; Frame

CODE NO.	NOM. SIZE (mm)	DIMENSIONS (mm)		
		L	A	B
2238 110 082	110x82	120	65	82.2
2238 160 082	160x82	175	65	82.2

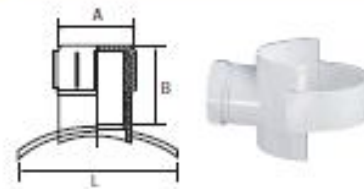

## Flat Roof Outlet

CODE NO.	NOM. SIZE (mm)	DIMENSIONS (mm)			
		A	B	C	D
52RV 369	110	280	157	214	122
52RV 482	160	380	170	250	148

Imported fittings

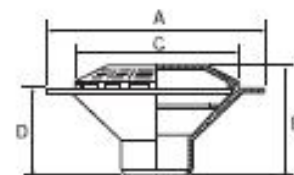

## Trapped Roof Outlet with Leaf-guard

CODE NO.	DIMENSIONS (mm)			
	A	B	C	D
1992504	100	110	74	62

Imported fittings

